



EARTHING CONNECTIONS - TMS

Conception and design

FORISSIER's earth connections are designed from flat braids made with tinned wire 0.20mm. The connecting pads are produced from tinned copper strips. The connecting pads are ended with a circular cutting to fit the connexions easily.

The range

- Standardized sections: 10 – 16 – 25 and 35 mm²
- Hole to hole length - LEA: 100 – 150 – 200 – 250 – 300 and 400 mm
- Wire diameter: 0.2mm – and 0.1 mm optional
- Strip thickness: 0.5mm
- Hole diameter: 5.5 – 6.5 – 8.5 -10.5 and 12.5 mm

Option

Other lenghts on request.

TECHNICAL SPECIFICATIONS

WIRES

Copper clasification	According to the French Standard NF EN 13602 (NFC 31 111)	
	Designation	Cu-ETP
	Min copper content	99.9 %
	Max electrical resistivity et 20°C	1.7241 μΩ.cm (100%I ACS) or 0.017241 Ω mm ² /m (100%I ACS)
Copper specifications	Mechanical resistance	200 mini Mpa

DESIGNATION

CS TP	25mm ²	CRE	20	LEA300
Earth connection	Section mm ²	Tinned copper	Wire diameter 20/100	Hole to hole length mm

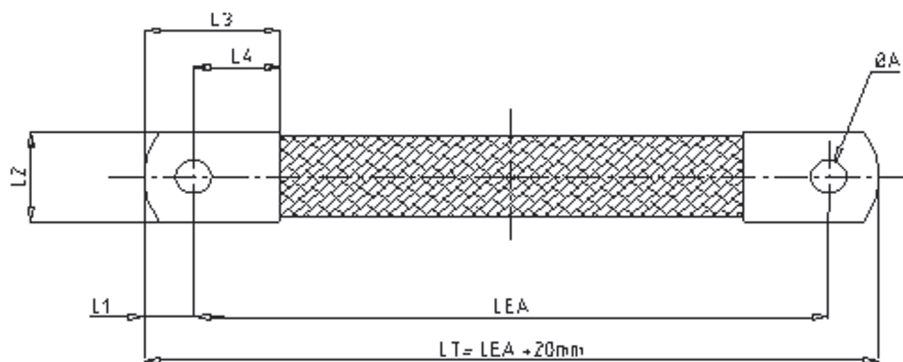

mm ² section	L1 mm	L2 mm	L3 mm	L4 mm	Dia A mm
10	10	17	22	12	5.5 - 6.5
16	10	17	22	12	6.5 - 8.5 - 10.5
25	10	21	23	13	6.5 - 8.5 - 10.5
30	10	21	23	13	8.5 - 10.5
35	10	21	23	13	10.5 - 12.5

